

TSDO | Trade Show Display Outlet Flat Tension Fabric Display Assembly Instructions
www.tradeshowdisplayoutlet.com

Note: Assembly is the same for all sizes of flat Companion II displays

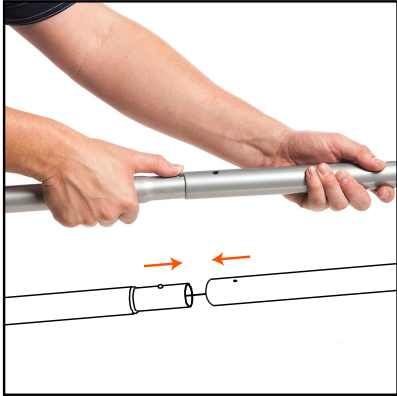

Straighten and assemble bungied poles.

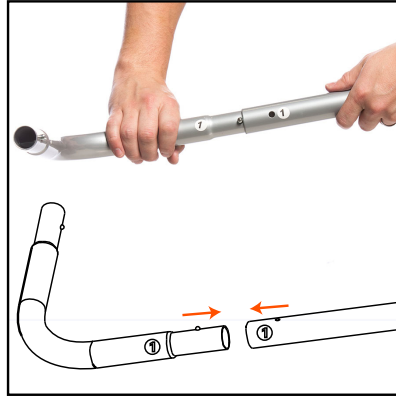

Connect poles to corners. Poles and corners are labeled for easy assembly.

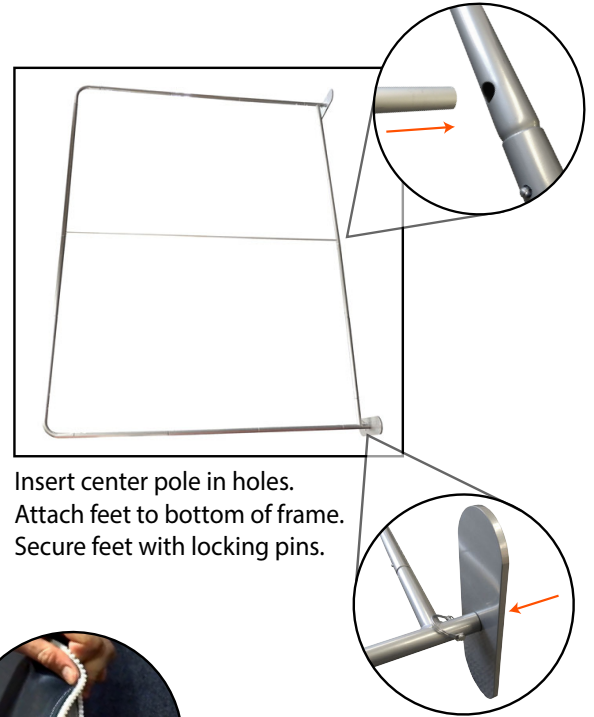

Insert center pole in holes. Attach feet to bottom of frame. Secure feet with locking pins.

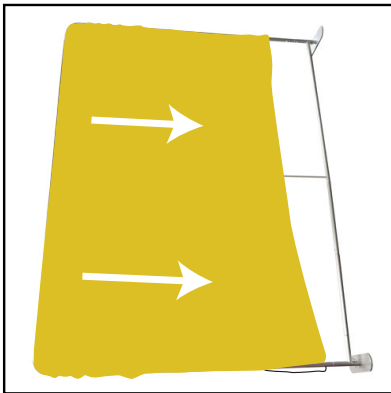

Lay frame on it's back. Attach feet to legs, securing with pin. Pull pillowcased graphic over frame.

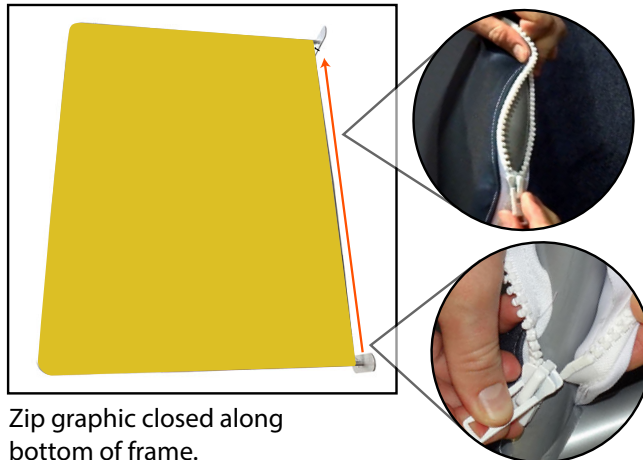

Zip graphic closed along bottom of frame.



Clamp optional lights on top bar.
 Tip: Put lights on before standing the display up.

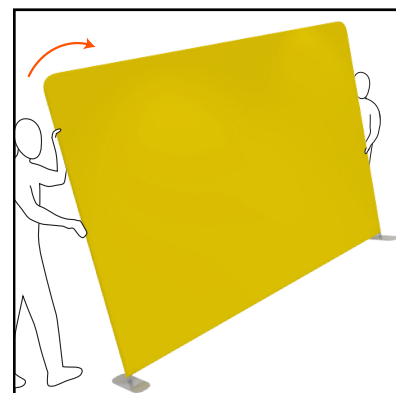

Stand display up.
 Note: This step is easier with two people.

